

IDENTIFICATION

South Carolina Inventory of Historic Places
Survey Field Form/Data Entry Form
State Historic Preservation Office
PO Box 11,669, Columbia, SC 29211
(803) 734-8577

1. CONTROL NUMBER: 0 / 19 / 1380 / 1750167
country census design-ated place site number

2. HISTORIC NAME(S):
3. OTHER NAME: Ehrhardt House
4. ADDRESS/LOCATION: 2108 Pettigrew St.

CITY: Sullivan's Island VICINITY OF: COUNTY: Charleston

5. OWNERSHIP: private(P) city(M) county(C) state(S) federal(F) 6. CATEGORY: building(B) site(S) structure(U) object(O)

7. HISTORIC USE(S): single family residence

8. CURRENT USE(S): single family residence

9. POTENTIAL: NR / NR historic district archaeological
10. STATUS/DATE: listed individually in National Register
name:
listed as part of NR historic district contributing non contributing
name of district:
listed individually National Historic Landmark part of NHL district
determined eligible - owner objection DOE process
determined NOT eligible
deferred by Review Board rejected by R B
rejected by Washington removed from NR
pending Federal nomination removed from survey
completed Preliminary Information Sheet demolished
nomination on file - never processed

11. NUMBER OF CONTRIBUTING PROPERTIES:

PROPERTY DESCRIPTION

12. CONSTRUCTION DATE: 1885c 13. ALTERATION DATE:

14. VERNACULAR FORM: 15. ARCHITECTURAL STYLE OR INFLUENCE:

16. DESCRIPTION:
a) construction masonry(MAS) frame(FRA) log(LOG) steel(STL) other(Z)

b) exterior wall material weatherboard(WB) beaded weatherboard(BWB) shiplap(SHP) stucco(STU) tabby(TAB)
wood shingle(WSH) brick(BRI) brick veneer(BRV) asbestos shingle(ABS) asphalt siding(ASP) flushboard(FBD)
synthetic siding(SYN) other(Z)

c) shape rectangular(R) square(S) L(L) T(T) U(U) H(H) octagonal(O) irregular(I) other(Z)

d) stories 1 1 1/2 2 2 1/2 3 4+ other(Z)

e) roof shape gable(end to front)(GEF) gable(lateral)(GBL) hip(HIP) cross gable(CRC) pyramidal(PYR) flat(FLT)
truncated hip(TRH) gambrel(GAP) mansard(MAN) salt box(SBX) other(Z)

f) roof material composition shingle(COS) pressed metal shingle(PMS) wood shingle(WDS) slate(SLT) builtup(BLI)
raised seam metal(PSM) corrugated metal(CRM) tar paper(TAR) not visible(NV) other(Z)

g) # of chimneys exterior end(EIF) interior end(INE) interior(INT) central(CEN) flue(FLU)
double shouldered(DS) other(Z)

h) chimney material brick(BR) stuccoed brick(SB) stone(ST) other(Z)

i) dormers gable(GAP) hip(HIP) pedimented(PED) swept(SWE) other(Z)

J) foundation brick pier(BP) brick pier with misc. fill(BPF) brick pier with brick fill(BPB) solid brick(BRI)
stone piers(STP) stuccoed masonry(STU) basement(BAS) raised basement(RBS) other(Z) CMU pier

k) porch height 1 story(1ST) 1 story with deck(1WD) 2 or more stories(2+) 2 or more with tiers(2+T) other(Z)

l) porch width entrance bay only(EBO) more than 1 bay, less than full facade(B+) full facade(FF)
facade and left elevation(F&L) facade and right elevation(F&R) wrap around(WFA) other(Z)

m) porch roof shed(SHD) hip(HIP) gable(GAB) pedimented gable(PDG) flat(FLT) engaged(ENG) other(Z)

n) porch details chamfered posts(CHP) turned posts(IP) posts on brick piers(PBP) columns(COL) balustrade(BAL) freestanding posts(FSP) sawn/turned work(S/T) enclosed end bay(EEB) other(Z) 2X4 w/ screening
o) windows single(SGL) double(DBL) paired(PRD) tripartite(IPT) grouped(GRP) decorative(DEC) display(DIS) other(Z) _____

p) pane configuration 1/1 2/2 3/1 4/1 6/6 9/9 9/6 other(Z) _____

q) shutters louvered(LOU) board and batten(B&B) paneled(PAN) other(Z) _____

r) doors single(SGL) double(DBL) transom(TRA) sidelights(SID) other(Z) French

s) decorative element material cast iron(CI) cast stone(CS) terra cotta(IC) granite(GR) wood(WD) pressed metal(PM) other(Z) _____

t) interior features: _____

17. OUTBUILDINGS: kitchen(KIT) slave house(SLH) tenant house(TE) other house(OH) garage(GAR) office(OFF) barn(BRN) tobacco barn(TOB) dairy(DAI) crib(CRB) smokehouse(SMK) shed(SED) privy(PVY) well(WEL) springhouse(SPF) none(N) none visible(NV) other(Z) _____

18. SURROUNDINGS: residential(R) residential/commercial(R/C) commercial(C) rural(RU) rural community(RCM) industrial(IND) other(Z) _____

19. ADDITIONAL DESCRIPTIVE COMMENTS Long narrow "L" shaped block w/ 4X4 bay addition to N; 2 metal attic ventilators @ roof; porch w/ cornice & sawn brackets; boxed cornice w/ returns; being re-sided w/ wood weatherboards. Porch roof appears to have been altered above cornice; 2 western bays

HISTORICAL INFORMATION enclosed. Principal entrance w/ transom, sidelights, 20. THEME(S): molded 4-panel door.

21. PERIOD(S): _____

22. IMPORTANT PERSON(S): _____

23. ARCHITECT(S): _____ SOURCE: _____

24. BUILDER(S): _____ SOURCE: _____

25. HISTORICAL DATA: Appears on 1917 plat & 1924 Sanborn map. Formerly summer cottage for Catholic Bishop of Charleston; had been occupied by members of O'Neill family prior to their building 2068 Pettigrew; owned by Ehrhardt family of Charleston for 30± years.

26. BIBLIOGRAPHY: INF: Arthur B. Schirmer, 2108 Atlantic; Samuel E. Harvey, Charleston SC

PROGRAM MANAGEMENT

27. QUADRANGLE NAME: 175 - Fort Moultrie

28. PHOTOGRAPHS: (Y/N) prints 2 slides _____ negatives _____ SI R8: 17, 19

29. OTHER DOCUMENTATION: survey back-up files(SF) National Register files(NRF) tax act files(TAF) grants files(GRF) state historical marker file(HMF) environmental review files(ERF) other(Z) _____

30. RECORDER NAME/FIRM: DBS / Preservation Consultants, Inc. SHEP

31. DATE RECORDED: 87 / 5 / 25
year month day

COMMENTS:

Modest example of late 19-early 20th century island architecture

Tax Map Number: 529-9-0-58

HURRICANE HUGO DAMAGE ASSESSMENT INVENTORY
 ADDRESS: 2108 Pettigrew Street
 NAME: Ehrhardt House

TMS 529-9-0-58
 SITE # 161
 Survey/• SI 167

TYPE: SFR WITH DEPENDENCIES _ OTHER:

OWNER NAME AND ADDRESS: Margaret James
 12 Meeting Street, Charleston SC 29401

NATIONAL REGISTER STATUS: POTENTIAL: Contributing: Sullivans Island Historic Districts

PREVIOUS SURVEY DATA

Construction Date: ca 1885 Date of Significant Alterations:
 A) Stories (not including basement): 1
 B) Foundation: CMU pier
 C) Principal Roof Shape: Cross-gable
 - Other:
 - Porch Roof Shape: Shed
 D) Principal Roof Material: Composition shingle
 - Porch Roof Material: same
 E) Dormers: -
 F) Chimneys: -
 G) Exterior Siding: Weatherboard (resided 1987)
 H) Principal Porch: Full facade
 - Other Porch:
 I) Porch Details: Sawn trim; insect screening; two left (west) bays enclosed
 J) Historic Shutters:
 K) Other Detail/ Trim Work Noted: Sawn brackets at porch cornice; transom, sidelights and molded four-panel door at principal entry. Boxed cornice with returns at gable ends.

ADDITIONAL DESCRIPTION:

Long narrow "L"-shaped building cited as "modest example of late nineteenth-early twentieth century island architecture."

Site Features: Walls _ Fences _ Gates _ Other:
 Outbuildings:

FIELD ASSESSMENT

DATE: 1/22/90

Depth of Flooding Noted:

	FACADE	RIGHT	LEFT	REAR	
A) Structural Damage					* ? - Code Red
B) Foundation					* 100% - house has been dislodged and shifted
C) Principal Roof					* 20% - sagging and missing shingles
D) Porch Roof					* NV
E) Dormers					* NA
F) Chimneys					* NA
G) Exterior Siding	20%	15%	NAD	15%	* missing boards
H) Porch Trim					* 100%
I) Windows	20%	50%	NAD	NAD	*
J) Detail/Trim Work					* ? - indeterminate b/c of extensive damage
K) Other					*

L) Site Features: Walls _ Fences _ Gates _ Other:
 M) Outbuildings:

NOTES: House was dislodged from its old foundation and swept back a good distance.
 It is surprising that the house has not been demolished

3/22/90 Town Permit - demolish (\$2312.50)

County of Charleston
property information system

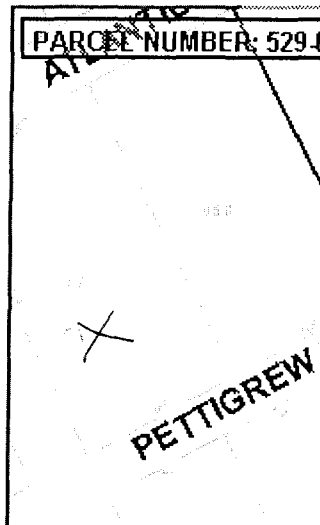

PARCEL NUMBER: 529-09-00-059-
 PARCEL NUMBER: 529-09-00-059
 ADDRESS: 2114 ATLANTIC AVE
 PROP SITE NM:
 GENERAL USE: SNGL-FAM-RES
 SUBDIVISION:
 LEGAL DESC: ~~LT 204~~ 280
 LGL HI ACRS:
 LGL MAR ACRS:
 LGL WATER ACRS:
 LGL SWP ACRS:
 LGL TOT ACRS:
 TAX DISTRICT: T.D. 2-3 SULLIVAN-ISL
 JURISDTN COD: CNTY-ASSESSR
 PLAT DB PAG: D-189
 OWNER ON 1ST: ADAMS FREDERKICK F III AS TRUSTEE
 CURRENT OWNER 1ST:
 SALE DATE: 09/07/1994
 DEED BOOK: P250561
 TITL WILL CD:
 TITL WILL DT:
 C O NAME:
 MAILING ADDRESS: 1550 BARBERRY LN SPARTANBURG SC 29302-3323
 SALE PRICE: 9
 MULT LOT:
 SPLIT CODE:
 MLOD GROUP:
 FINAL VALUE: 1037000
 BUILD COUNT: 1
 AG USE VAL:
 AG MARKT TOTAL:
 LR APPROVE: NO
 YEAR BUILT: 1992
 NUM BEDROOMS: 4
 FULL BATHS: 3
 THREE QTR BATHS:
 HALF BATHS:
 TOTL FN AREA: 4282
 FIN LIV AREA:
 FULL BEDROOM:
 FULL BATHS:

-
-
-
- owner
- address
- parcel number
-
- aerial image

Please send all questions and comments concerning this web site to: webmastergis@charlestoncounty.org
 Site updated on November 16, 2004. Data reflects deed and plats processed by the Auditor and Assessor as of that date. © Copyright 2000-2004, Charleston County Government. All rights reserved.

CHARLESTON COUNTY *Auditor* Peggy A. Moseley

- [MAIN MENU](#)
- [EXIT](#)

Parcel ID
5290900058

Sub-Division

Legal Description :LT 280

Acreage High : 0 Marsh : 0 Swamp : 0 Water : Total : 0

Jurisdiction : CNTY-ASSESSR

Property Address :2114 PETTIGREW ST

Mailing Address : 0 PO BOX 307, SULLIVANS ISLAND- SC, 29482-0307

Current Owner - 1	Current Owner - 2	Owner 1 as of Jan 1	Owner 2 as of Jan 1
-	-	ROBINSON LESLIE G	ROBINSON BARBARA

**CARD
IMAGE**

**PLAT
COMMENT**

**OWNER
COMMENT**

For Plat Comment and Owner Comment information on plats and deeds recorded prior to 01/05/2004, please

Basic deed transfer information is complete back to 1991.

For records and transactions preceding that date, please click on Card Image button

© Copyright 2004, County of Charleston, South Carolina. All rights reserved. Legal Disclaimer

Immediate Damage

Total Loss/Unsalvageable

Severe X
Moderate
Slight
None Noted
Other

SITE #: 161

Location: SULLIVANS ISLAND

Category:

NR
NRHD
Pot. NR
Pot. NRHD X

Status as of : 3/22/90

Total Loss X
Pre-Storm Condition
Altered
To Be Repaired
Unknown

Sources

Field Assessment X
Field Informant
Owner Reply
Permit Records X
Engineering Code Red X
Town Appearance Comm.

Photo: M3 : 7,8





